



RoboEVO
EQUIPMENT

SNOW BLADE



ENERGREEN America
1242 Nowell Dr · Augusta
GA 30901 · USA
Phone CA 510 593 3144
Phone GA 706 945 2800

info@energgreenamerica.com
www.energgreenamerica.com

PROFESSIONAL MACHINES AND EQUIPMENT



09/2021 - © Energreen America 2021 - All rights reserved - Photo, technical and constructive characteristics subjected to modification without reporting requirement.



TECHNICAL DATA SHEET
SNOW BLADE

Tool with plastic or steel blade, hydraulically adjustable, ideal for the sector of the cleaning and removing the snow from roads, sidewalks, squares, car parks, ramps, etc. also in areas with steep slopes. It is equipped with pressure springs for the overcoming of possible unexpected obstacles. Inclination of $\pm 20^\circ$ through hydraulic cylinders with pressure relief valves. Easy substitution of the knife, thanks to several fixing bolts. In addition, this blade is fitted with base feet and supporting spinning wheels.

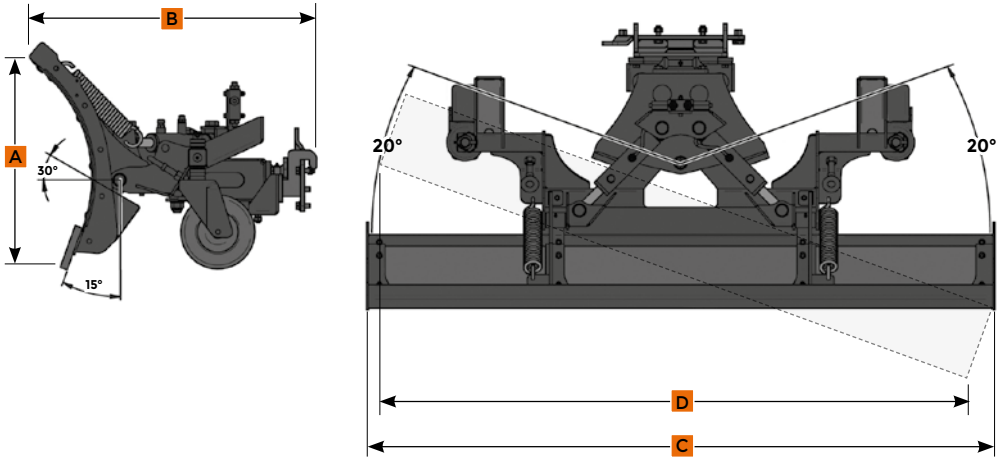

TECHNICAL DATA			
(A) Blade height	24 in	Knife	Plastic or steel
(B) Depth	30 in	Inclination angle	20°
(C) Blade width	67 in	Oscillation angle	$\pm 13^\circ$
(D) Width at 20°	63 in	Weight	271 lbs

